

\$587,651 - 4813 Zilker Avenue, Carrollton

MLS® #14581694

\$587,651

4 Bedroom, 3.10 Bathroom, 2,930 sqft
Residential on 0.10 Acres

Essex Park, Carrollton, TX

NORMANDY HOMES WESTCHESTER floor plan. New two-story home in the sought after community of Essex Park. This 4 bedroom, 3.5 bath home features a wide open floor plan with an over-sized study. Walk into this amazing kitchen with multiple, beautiful painted cabinets and up-graded kitchen countertops. Turn the corner to a large, main floor owner's suite. Quartz countertops featured in every bathroom. Home consists of contemporary white and gray finishes, with LVP throughout all the main areas. Walk up-stairs to spacious game room with upgraded carpet throughout all bedrooms. This amazing home is nestled in the perfect location—right across from the model! This jewel will not last!

Built in 2021

Essential Information

MLS® #	14581694
Price	\$587,651
Bedrooms	4
Bathrooms	3.10
Full Baths	3
Half Baths	1
Square Footage	2,930
Acres	0.10
Year Built	2021
Type	Residential

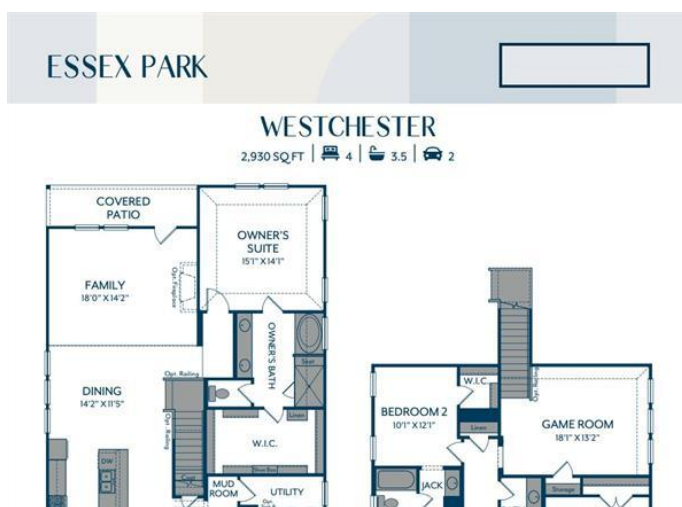

Sub-Type	Single Family
Style	Traditional
Status	Active Contingent

Community Information

Address	4813 Zilker Avenue
Subdivision	Essex Park
City	Carrollton
County	Denton
State	TX
Zip Code	75010

Amenities

Utilities	City Sewer, City Water, Community Mailbox, Concrete, Curbs, Individual Gas Meter, Individual Water Meter, Sidewalk, Underground Utilities
Features	Park, Playground
# of Garages	2
Garages	Attached, Front, Garage Door Opener, Garage

Interior

Interior Features	Cable TV Available, Decorative Lighting, High Speed Internet Available, Smart Home Features
Appliances	Built-in Microwave, Cooktop - Gas, Dishwasher, Disposal, Oven - Electric, Plumbed for Gas in Kitchen, Vent Mechanism, Water Line to Refrigerator
Heating	Central Air-Elec, Central Heat-Gas
# of Stories	2
Stories	2

Exterior

Exterior Features	Covered Porch(es), Gutters, Patio Covered, Sprinkler System
Lot Description	Interior Lot, Landscaped, Lrg. Backyard Grass, Some Trees, Subdivision
Windows	Double Pane Windows, Low E Windows
Roof	Composition
Construction	Brick, Rock/ Stone, Stucco, Wood
Foundation	Slab

School Information

District	Lewisville ISD
Elementary	Indian Creek

Middle	Arborcreek
High	Hebron

Listing Details

Listing Agent	Carole Campbell
Listing Office	Colleen Frost Real Estate Serv

Users may not reproduce or redistribute the data found on this site. The data is for viewing purposes only. Data is deemed reliable, but is not guaranteed accurate by the MLS or NTREIS.

Listing information last updated on January 27th, 2022 at 11:32am CST